

## LIVING ON THE EDGE OF REFORESTATION

( HANNAH BERGSTRAND NOTTINGHAM-UK, MICHAEL  
TOWNSEND NOTTINGHAM-UK, GRAHAM LEWIS  
NOTTINGHAM-UK, DAVID TILLEY NOTTINGHAM-UK )

The Living on the Edge design encourages residents to live sustainably off the forest through crop and farm maintenance, while enabling communities to rebuild their forests and to tackle deforestation. Nigeria has lost 36 percent of its trees over the past 25 years and the state of Edo has greatly contributed through the growth of logging and oil industries. Edo lost over 89,000 ha of forest between 2001 and 2012.

Drawing on a nomadic lifestyle familiar to many families living near the remaining forests, the design provides temporary dwellings on the forest perimeter. The community will move as the forest grows with former dwellings left to return to a natural state as families move to the new forest edge.

While based on local traditions, the tree housing is extremely modern and simple to construct. Each dwelling is assembled with composite panels made from balsa, a fast growing, lightweight hardwood. Adjustable legs and a simple truss raise the house off the forest floor freeing land for crop and sapling growth. Access is provided via bridges and ladders to reduce the impact on the ground. The elegant and practical raised dwellings enable an entire community to develop in the forest's canopy.

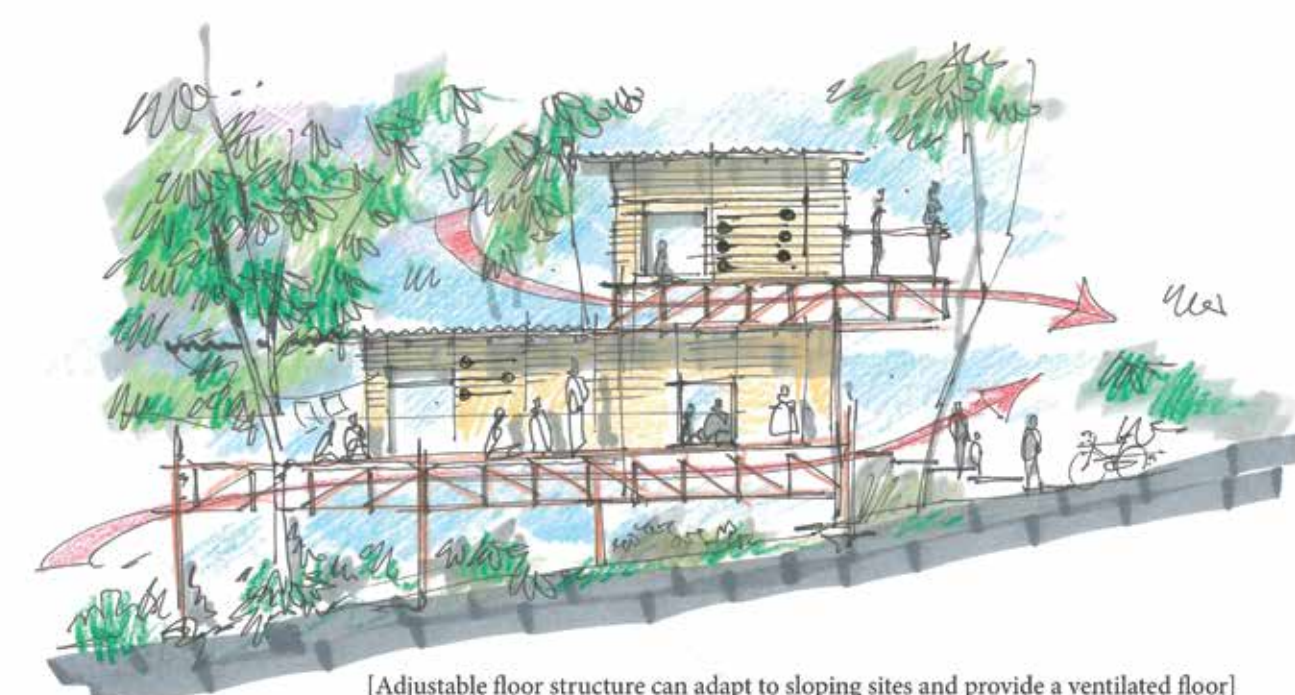
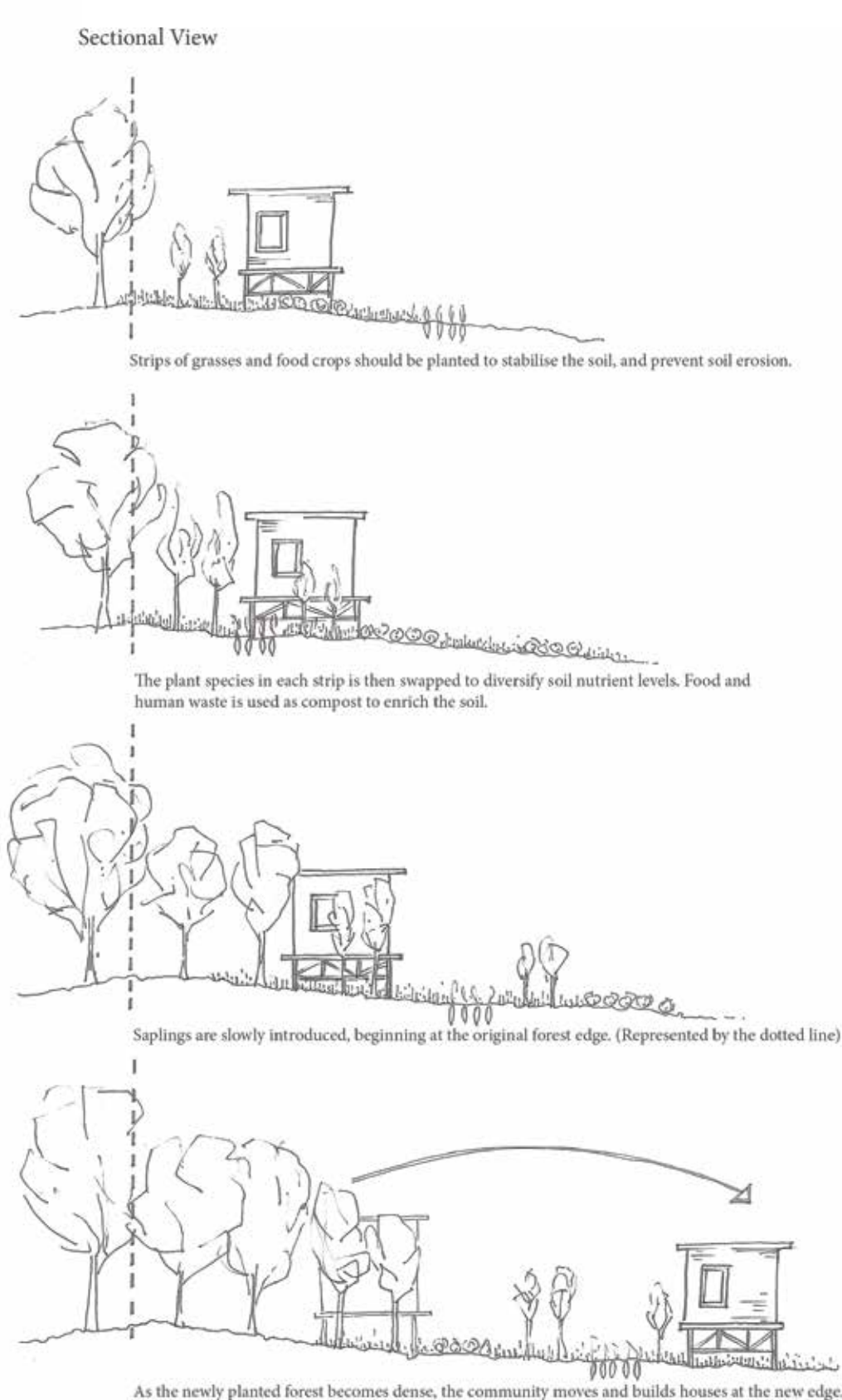
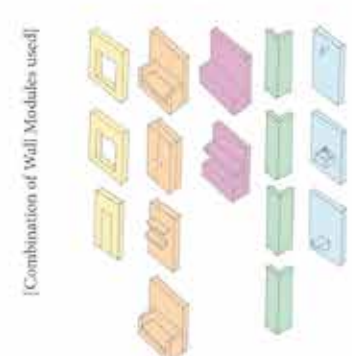
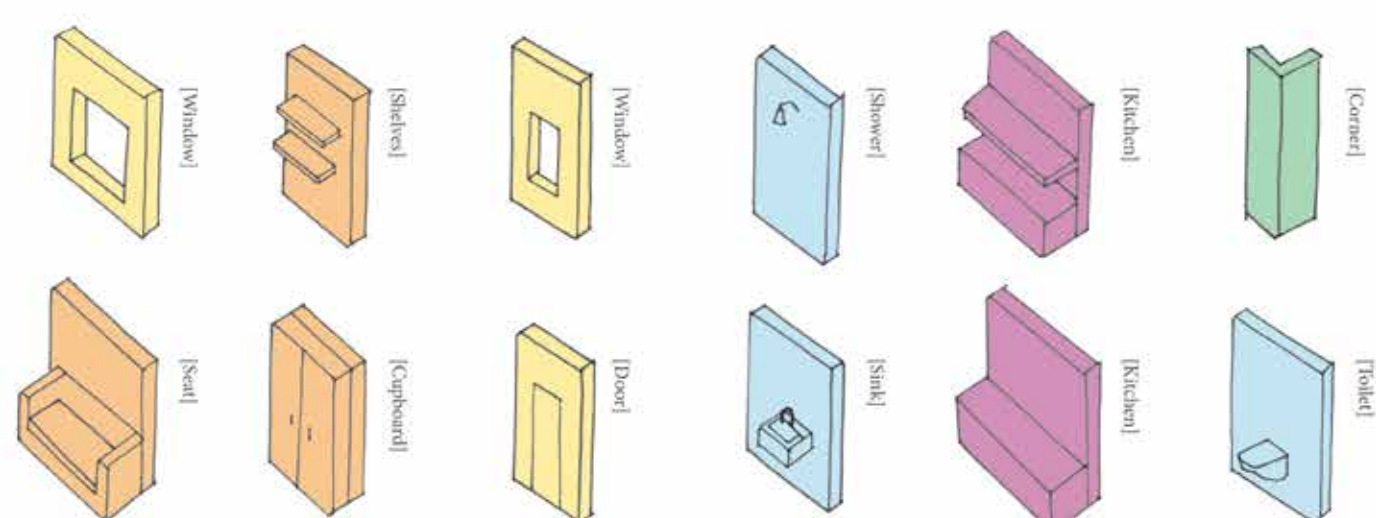

[Adjustable floor structure can adapt to sloping sites and provide a ventilated floor]



[A typical arrangement of an interior space]

Each dwelling is assembled with composite panels made from balsa, a fast growing, lightweight hardwood. Adjustable legs and a simple truss raise the house off the forest floor freeing land for crop and sapling growth.

Access is provided via bridges and ladders to reduce the impact on the ground. The elegant and practical raised dwellings enable an entire community to develop in the forest's canopy.