

# Land Market in Bulgaria 2012 and Voluntary LC vs. Climate Change

*Radoslav Manolov, BAALO and Kiril Stoyanov, Ministry of Agriculture  
and Food, Bulgaria*

## FACTS ABOUT THE BULGARIAN AGRICULTURE

- 5 400 000 ha Agricultural Land
- 3 620 900 ha Utilized agricultural area (UAA)
- 358 000 agricultural holdings
- 751 000 people involved in agriculture (10% of population)
- 80% of UAA is rented or leased
- 40 000 long term lease contracts

## RENT PRICES 2006-2013

YEAR	06/07	07/08	08/09	09/10	10/11	11/12	12/13
Average rent price in €/ha	60	70	90	100	120	140	180

## LAND TRANSACTIONS 2003-2012

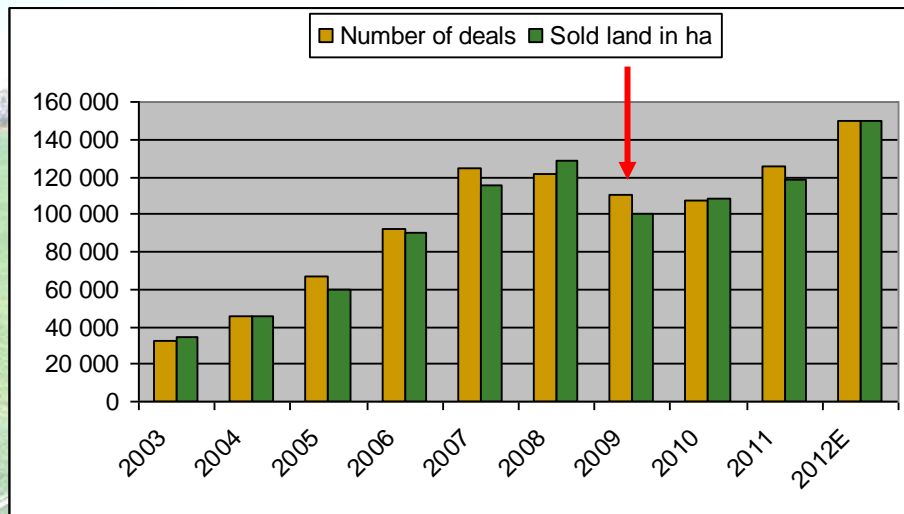

## LAND PRICES

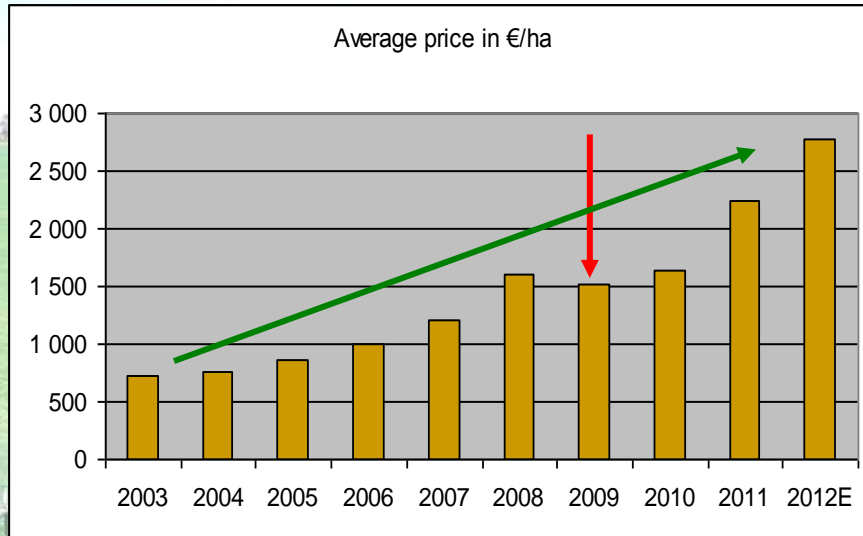

## LAND BANKING STATE TENDERS

- Public State land tender in 26 out of 28 regions
  - 8500 ha of 10 000 plots sold
  - Effective price 2500 Euro/ha average (compensation bonds)



An aerial photograph of a vast, green agricultural field. A long, straight irrigation system, possibly a center pivot, runs diagonally from the bottom left towards the center of the frame. A blue tractor is visible near the end of the irrigation line. The field is surrounded by a fence in the background, and there are some trees and structures in the distance under a clear sky.

## LAND BANKING

### PRIVATE DIRECT DEALS

- **Advance Terrafund REIT**
  - 7700 ha sold
  - 4500 Euro/ha average
- **Private Direct Negotiations in 20 Regions out of 28**

- 
- An aerial photograph of a vast, green agricultural field. A long, straight irrigation system, possibly a center pivot, runs diagonally from the bottom left towards the center of the frame. A blue tractor is visible near the end of the irrigation line. The field is surrounded by a fence in the background, and there are some trees and structures in the distance under a clear sky.
- ## LAND BANKING
- ### PRIVATE DIRECT DEALS
- **Advance Terrafund REIT**
    - 7700 ha sold
    - 4500 Euro/ha average
  - **Private Direct Negotiations in 20 Regions out of 28**

# STAGES IN THE LAND CONSOLIDATION PROJECT

The map illustrates the stages in a land consolidation project. It shows a complex arrangement of land parcels, some of which are numbered (e.g., 110, 113, 114, 121, 122, 124, 125, 126, 128, 129, 130, 133, 146, 147, 148, 152, 218, 225, 234). The map is color-coded according to a legend on the left, which includes categories like 'KATEGORIA' (Category), 'KOD' (Code), and 'KOLOR' (Color). The legend lists various land use types and their corresponding colors and codes, such as 'KATEGORIA: KOD: KOLOR'. The map also features a scale bar and a north arrow.



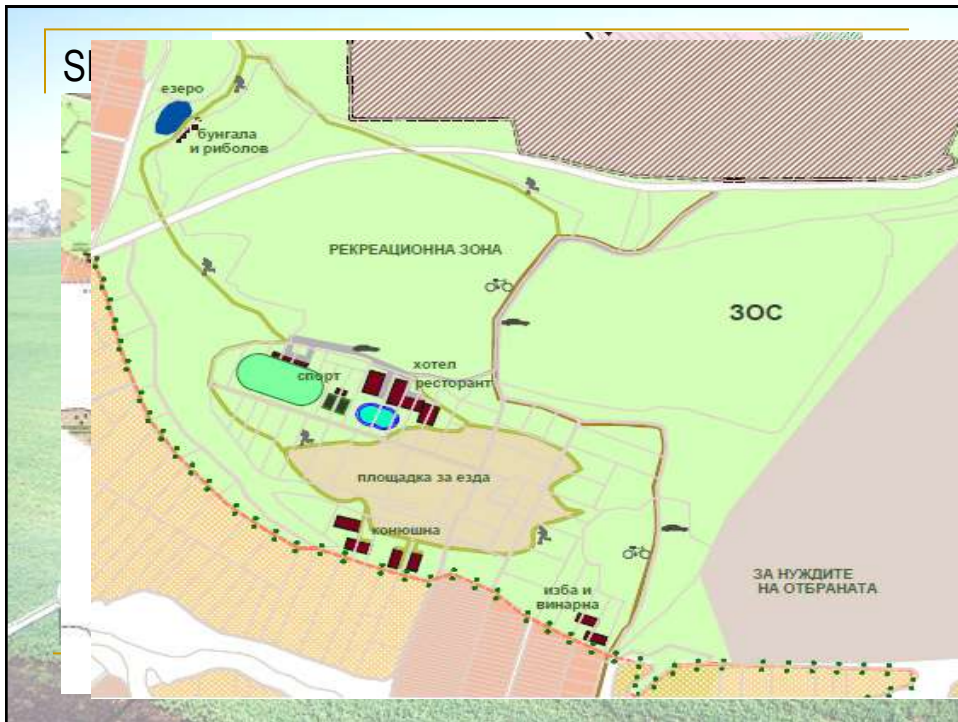

**THANK YOU FOR YOUR ATTENTION!**

- **PLEASE DO NOT HESITATE TO ASK QUESTIONS!**

